



**Ross Schroder**  
083 519 0905  
ross@officeplace.co.za

Contact Cape Town

021 9112906

Block 4, Portion of 1st Floor  
Unit 403, De Tijger Office Park  
Cnr McIntyre & Hannes Louw Drive  
Parow



Web Ref CS9500CCTL

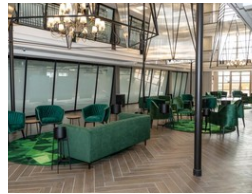

## No. 1 Waterhouse

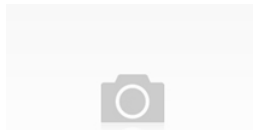

**Offices (9)**  
From R165 per m<sup>2</sup>  
Size from 231m<sup>2</sup> to 1,379m<sup>2</sup>

### No 1 Waterhouse Offices To Rent in Prime Waterford Place Office Precinct, Century City

No. 1 Waterhouse is a premium office development situated in the sought after Waterford Place Office Precinct of Century City. Flexible floor plates ranging from 2000 - 3 000 sqm per floor and allow for layouts starting from 200 sqm users. The main atrium is fitted with acoustic grade glass providing natural light without sacrificing productivity. The building includes an upmarket deli style coffee shop together with numerous internal and external break away areas for casual meetings. Ample parking with secure access to the building.

Amenities are within walking distance of No.1 Waterhouse including the newly developed Century...

### Features

- ✓ Offices ranging from 231sqm to 1379sqm
- ✓ Fibre connectivity
- ✓ Close to amenities such as Canal Walk Shopping Centre
- ✓ 4 parking bays per 100sqm available
- ✓ Main atrium includes a deli/coffee shop

